



*Progressive Motors
with Increased Output*



Unit 2, Crossley Mills, New Mill Road, Honley, Holmfirth, HD9 6QB, England

Tel: +44(0)1484 660222 Fax: +44(0)1484 660333

Web-site: www.kenworthproducts.co.uk

e-mail: enquiries@kenworthproducts.co.uk

Three-Phase Motors with Increased Rated Output

Totally Enclosed Motors IP55 Insulation Class F

Performance Data													
Type of Motor	Rated Output		Speed	Torque	Efficiency	Power Factor	Full load Amps		Locked Rotor Torque	Locked Rotor Current	Breakdown Torque	Moment of Inertia	Weight B3
	P _N		n _N	C _N	μ	COS φ	I _N at rated voltage		C _s /C _N	I _s /I _N	T _B /T _N	J _z	
	[kW]	[HP]	[rpm]	[Nm]	[%]		230v	400v				[kgcm ²]	[kg]
2 - pole n_s=3000 rpm													
PEMT 63-2C	0,37	0,5	2780	1,27	67	0,81	-	1,0	2,44	3,62	-	2,10	5,0
PEMT 71-2C	0,75	1	2800	2,53	76	0,73	-	2,0	5,00	5,58	-	4,65	7,0
PEMT 80-2C	1,5	2	2800	5,08	77	0,80	-	3,5	3,19	4,86	-	7,95	10,5
PEMT 90L-2B	3	4	2860	9,97	81	0,78	-	6,9	3,98	7,00	-	14,25	15,8
PEMT 100-2B	4	5,5	2900	13,10	76,5	0,88	-	8,6	2,82	6,70	-	24,82	21,9
PEMT 112M-2B	5,5	7,5	2900	18,00	83,5	0,78	-	12,1	2,41	6,01	-	41,41	31
PEMT 132M-2B	11	15	2910	35,75	88,5	0,81	-	22,0	3,20	7,10	-	127,52	56
PEMT 132M-2C	15	20	2900	49,00	90,5	0,88	-	27,0	2,70	7,30	-	149,62	60
4 - pole n_s=1500 rpm													
PEMT 112M-4B	5,5	7,5	1430	36,58	85,2	0,77	-	12,10	2,25	5,10	-	83,65	32,9
PEMT 132M-4B	11	15	1450	72,20	87,0	0,79	-	23,0	1,77	4,65	-	274,08	63
6 - pole n_s=1000 rpm													
PEMT100L-6P	1,8	2,5	930	18,10	74,0	0,72	-	4,6	1,73	4,20	-	67,30	33

For all other technical data please refer to E.M.G's standard three phase efficiency 2 catalogue.

IM B5

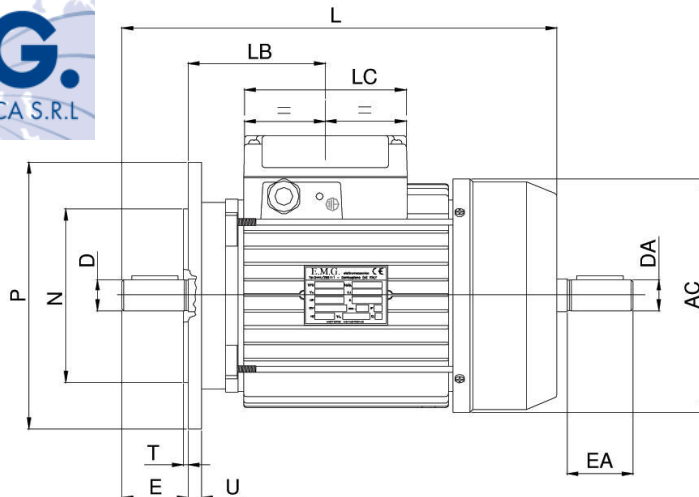

IM B14

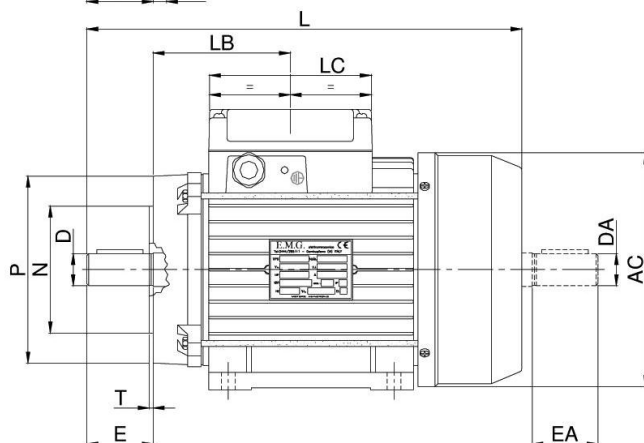

Overall Dimensions

	HB	L	D/DA	E/EA	V	Z	LB	LC	LD	ME	PG
56	88	188	9	20	10,2	M4	70	90	79	M12	9
63	95	207	11	23	12,5	M4	78	101	79	M16	-
71	104	243	14	30	16	M5	90	111	79	M16	-
80	115	280	19	40	21,5	M6	101	123	88	M20	-
90S	120	305	24	50	27	M8	102	123	88	M20	-
90L	120	330	24	50	27	M8	104	123	88	M20	-
100L	134	363	28	60	31	M10	92	90	90	M25	16
112M	150	383	28	60	31	M10	104	112	112	M25	16
132S	178	458	38	80	41	M12	111	112	112	M25/32	16/21
132M	178	497	38	80	41	M12	111	112	112	M25/32	16/21

Size	Standard B5 flange						Reduced B5 flange						B14 flange				
	M	N	P	S	T	U	M	N	P	S	T	U	M	N	P	S	T
56	100	80	118	7	3	7.5	-	-	-	-	-	-	65	50	80	M5	2,5
63	115	95	140	9,5	3	9	-	-	-	-	-	-	75	60	90	M5	2,5
71	130	110	160	9,5	3,5	8	115	95	140	9	3,5	3,5	85	70	105	M6	2,5
80	165	130	200	12	3,5	9	130	110	160	9,5	3,5	3,5	100	80	120	M6	3
90S	165	130	200	13	3,5	10	130	110	160	9,5	3,5	3,5	115	95	140	M8	3
90L	165	130	200	13	3,5	10	130	110	160	9,5	3,5	3,5	115	95	140	M8	3
100	215	180	250	14	4	10	165	130	200	12	3,5	3,5	130	110	160	M8	3,5
112	215	180	250	15	4	12	165	130	200	11,5	3,5	3,5	130	110	160	M8	3,5
132S	265	230	300	14	4	15	215	180	250	14	4	4	165	130	200	M10	3,5
132M	265	230	300	14	4	15	215	180	250	14	4	4	165	130	200	M10	3,5

IM B3

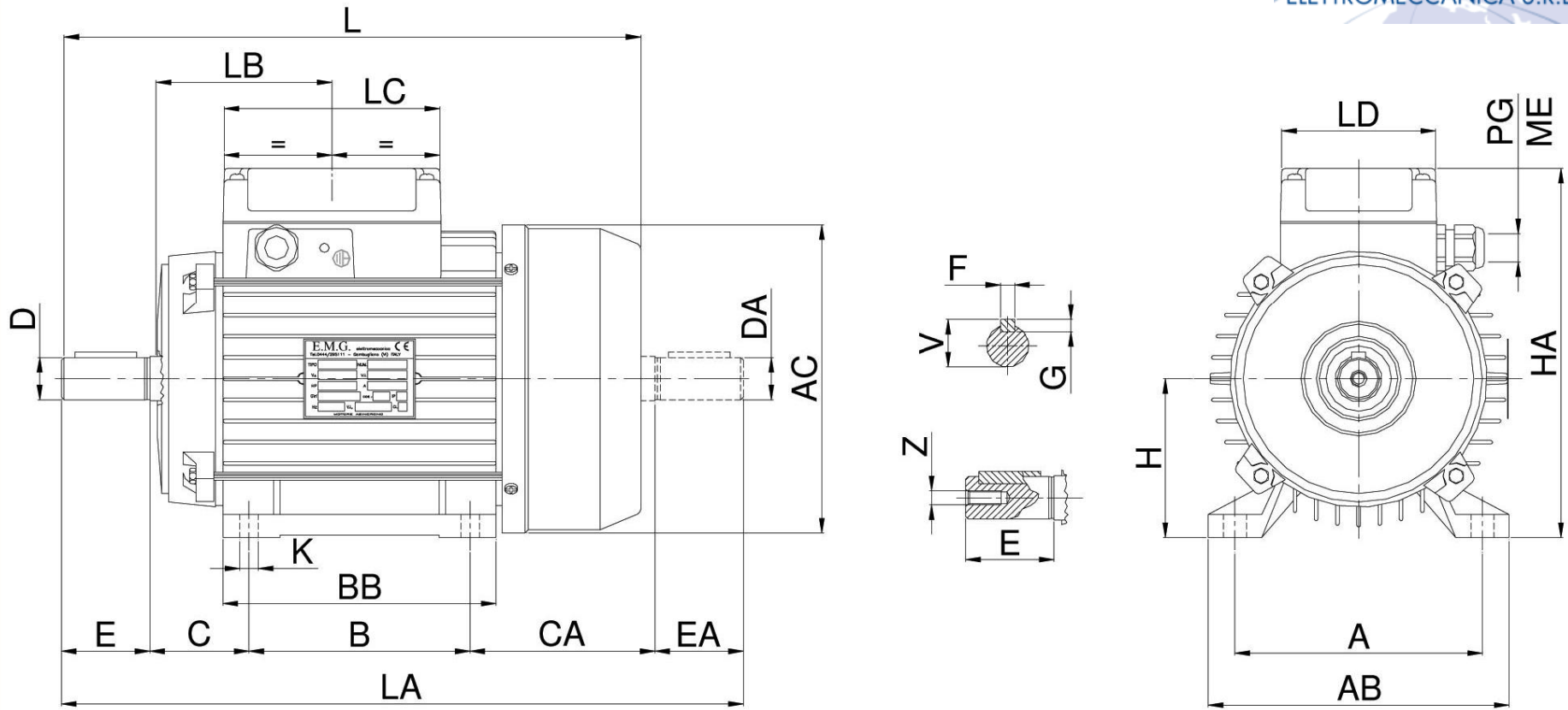

Size	H	HA	L	LA	C	AC	CA	AB	BB	A	B	K	D/DA	E/EA	V	Z	LB	LC	LD	ME	PG
56	56	144	188	208	35	112	61	107	90	90	71	6	9	20	10,2	M4	70	90	79	M12	9
63	63	158	207	230	38	127	65	120	100	100	80	7	11	23	12,5	M4	78	101	79	M16	-
71	71	175	243	273	45	145	78	135	109	112	90	7	14	30	16	M5	90	111	79	M16	-
80	80	195	280	326	51	159	95	152	125	125	100	9	19	40	21,5	M6	101	123	88	M20	-
90S	90	210	305	360	56	177	105	170	131	140	100	10	24	50	27	M8	102	123	88	M20	-
90L	90	210	330	386	56	177	105	170	155	140	125	10	24	50	27	M8	104	123	88	M20	-
100	100	234	363	432	61	193	111	192	171	160	140	12	28	60	31	M10	92	90	90	M25	16
112	112	262	383	450	68	220	115	220	183	190	140	13	28	60	31	M10	104	112	112	M25	16
132S	132	310	458	552	87	260	165	260	180	216	140	13	38	80	41	M12	111	112	112	M25/3	16/21
132M	132	310	497	592	87	260	165	260	218	216	178	13	38	80	41	M12	111	112	112	M25/3	16/21